

## Product Brochure For W2723

### Laser Fume Extraction - MMF-4L

High Volume up to 4000 m3/h Air Filtering Capacity  
99.99% Efficiency



**Ex GST**                      **Inc GST**  
**\$17,020.00**    **\$19,573.00**

ORDER CODE:	W2723
MODEL:	MMF-4L
Extraction Arm/Hose Length (Metre):	~
Extraction Arm Diameter (mm):	~
Air Flow (m3/h):	4000
Filtering Area (m2):	82
Inlet Size (mm):	250
Filter Type:	Ahlstrom
Filtration Efficiency:	99.99%
Collector Capacity (L):	45
Voltage / Amperage (V / A):	415 / 15
Motor Power (kW):	5.5
Compressed Air Requirements (Mpa):	0.6
Air consumption (m3/min):	0.32
Main Unit Size (w x l x h) (mm):	1380 x 1350 x 2200
Nett Weight (kg):	700



#### Description

The Metalmaster Fume Extraction Units are designed to keep your machine and workshop clean by removing harmful dust and particles. Specifically designed to work with laser cutting machines, these advanced dust collectors effectively capture and filter out the tiny particles created during the laser cutting process.

The filter is equipped with automatic jet pulse cleaning so the system automatically cleans itself.

#### Features

- High Volume high-efficiency filtration system
- Intelligent Control System with 4.3" Touch Screen
- Robust design
- Designed specifically for laser cutting
- Siemens motor, ultra-high negative pressure fan
- Supports remote start from Laser machine

#### Optional Accessories

- Air Ducting to suit your installation

Product Brochure For W2723

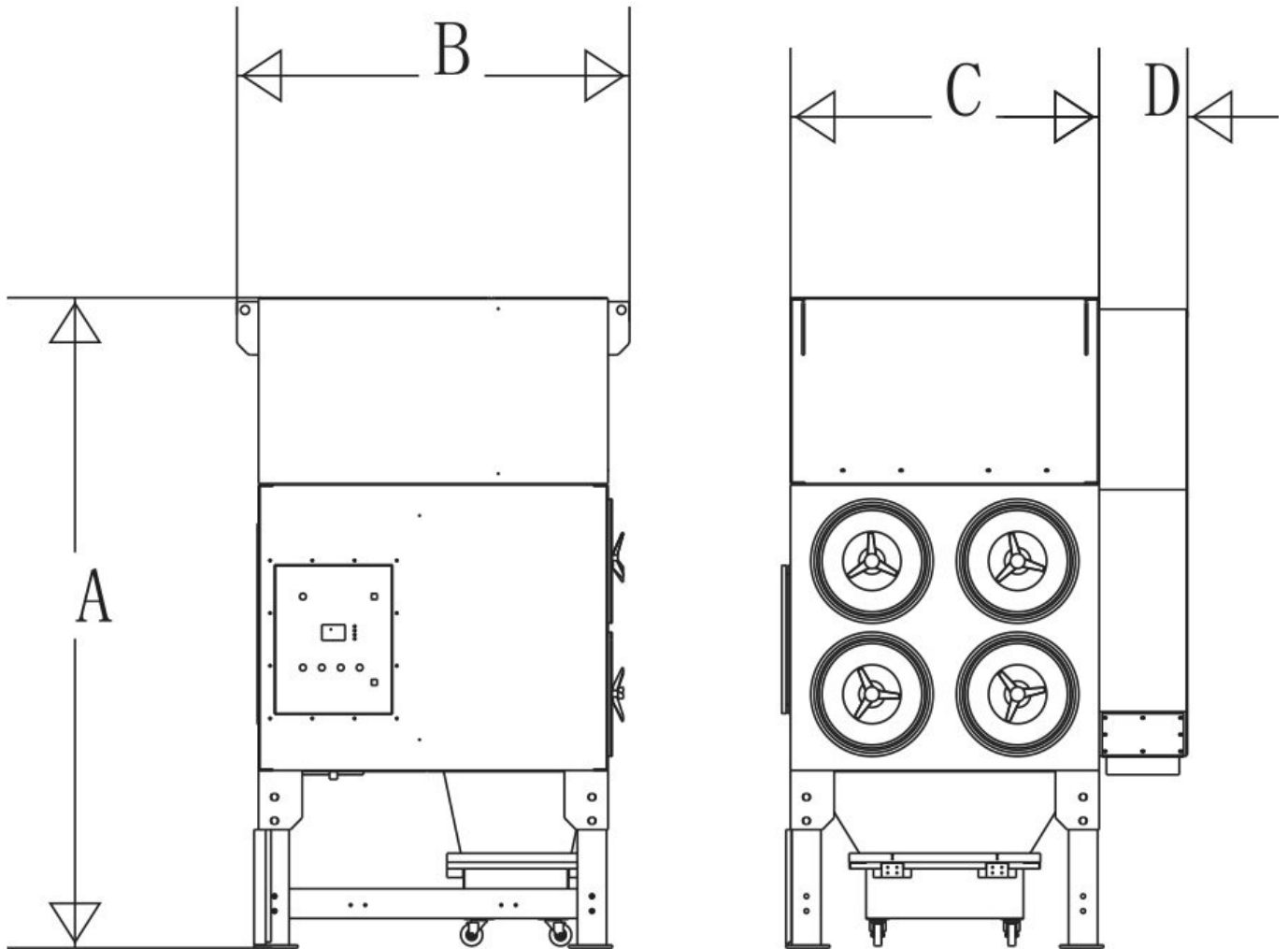

A :2198; B 1348; C 1060; D 303