

## Product Brochure For K058A

# Hydraulic NC Guillotine & NC Pressbrake Package Deal - HG-1060B & PB-135B

Guillotine - 3100 x 6mm, Pressbrake 3200mm x 135 Ton

Guillotine Ezy-Set NC-89 Control, Pressbrake Estun E21 NC Control



ORDER CODE:	K058A
MODEL:	HG-1060B & PB-135B
Shearing Capacity - Mild Steel (mm):	6
Shearing Capacity - Stainless Steel (mm):	3
Shearing Length (mm):	3100
NC Control (Type):	~
Backgauge (Type):	~
Backgauge Travel (mm):	700 / 600
Pneumatic Sheet Supports:	~
Quick Action Blade Clearance Adjustment:	Yes
Strokes / min (SPM):	12
Blade Angle (deg):	2° 30
Throat Depth (mm):	~
Motor Power (kW / hp):	7.5 / 10
Voltage / Amperage (V / amp):	415
Floor Space Requirements (L x W x H) (mm):	~
Nett Weight (kg):	13030

METALMASTER



## Features

- HG-1060B GUILLOTINE: 3100mm x 6mm
- 3100mm x 6mm cutting capacity
- 7.5kW / 10hp 415V motor
- Ezy-Set NC-89 Go-To digital display controlled backgauge with DRO counter
- Quick action blade clearance adjustment for shearing material 1 - 6mm
- Hydraulic material clamping for accurate shearing
- One shot lubrication pump & reservoir for slideway protection
- Squaring arm incorporating flip over stops
- Roving foot pedal control
- Clamp beam design allows clear view to shadow line on material
- Blades made from 9CrSi material suitable for cutting stainless steel
- Plate support tables with transfer balls for quick & easy material alignment and manoeuvrability
- Front sheet supports with ball bearing guides preventing material damage when setting up
- Safety three photo electric light beams on rear guarding
- Safety reset rear guarding button mounted to back of electrical box
- Heavy duty under driven machine construction
- Equipped with shadow line lighting-alignment device
- Mild steel capacity is rated on hot rolled material with 250MPA
- PB-135B PRESSBRAKE: 3200 x 135 Ton
- Hydraulic / Mechanical ram, synchronised positive stop design, ram stroke controlled by precision mechanical nut depth stops built into each cylinder. Electronically controlled by Estun NC-E21 Programmable digital control assuring accurate repeatability.
- Parallelism is ensured by torsion bar that can be easily adjusted by clutch system.
- Estun NC-E21 programmable digital control stores up to 40 unique programs with 25 automatic progressive bending steps in each individual program, assuring production accuracy & repeatability every time.
- Estun NC-E21 programmable hardened ballscrew backgauge system, simply enter the desired measurement into the controller and press go, the backgauge then will move quickly into the position you have requested. The superior hardened ballscrew system eliminates any backlash that leadscrew type machines produce.
- Segmented heavy duty 86° offset top punch is segmented for return bend clearance, complete with European style punch holder with an adjustable wedge clamping system for crowning.
- Intermediate clamp has safety key to stop punch dropping.
- Multi vee ('V') bottom die is made from one 3200mm solid die block design to handle heavy plate, safety edge vee ('V') is incorporated in bottom die block.
- Conveniently mounted control box on pendant for quick swivel and adjustments.

## Product Brochure For K058A

- Mono-block steel frame design, welded then machined to ensure minimal bed deflection under load
- Enclosed rear gate with micro safety switches complete with sliding rear door for easy access.
- European Intermediate clamping system, allowing operator to change position of tooling to suit multiple requirements on complex applications. This feature ensures minimum down time, more productivity and results in reduced cost per finished product.
- Sliding steel fabricated sheet supports enabling a wide range of material sizes to be aligned and supported at the correct required height. This feature is achieved with a "T" slot machined down the total length of the die bed, sheet supports are also adjustable vertically to assist in supporting material with return bends already folded.
- Adjustable sliding blocks control the machines beam to provide desirable open height distance to the (slow speed) mute bending point.
- Operator adjustable locking knobs for quick adjustment, enables accurate repeatability and increased productivity.
- Metal safety guarding surrounding the machine with rear sliding door fitted and micro switch ensuring operator safety.
- Clear access panels placed at each end of machine allows the operator to clearly view tooling and work piece during bending operation. MetalMaster specially design gates to suit Australian safety requirements.
- Hydraulic MPA pressure gauge mounted on right side of support frame with quick adjusting pressure control knob allowing operator to accurately set the pressure required for different material thickness, incorporating with hydraulic overload protection.
- Welded steel fabricated synchronised torsion bar horizontally supporting main bending beam to provide consistent parallelism that also can be adjusted for taper correction.
- The vertical supporting slides are treated to provide greater wear resistance and increased accuracy.
- Reinforced side frames providing addition support strength to machine throat.
- Includes safety control guarding system with light curtains fitted
- Mild steel capacity is rated on hot rolled material with 250MPa.

### Includes

- HG-1060B GUILLOTINE:
  - Rapid blade gap adjustment
  - Emergency stops fitted on both ends of machine for additional safety
  - Shadow line lighting allows operator to quickly see the cut line
  - 700mm Ezy-Set NC-89 Go-To via backgauge with fine adjustment
  - Swing away backgauge function for cutting long sheets
  - 4 edge quality 9CrSi blades suitable for stainless steel
  - Transfer balls on table & support arms
  - Heavy duty support arms and squaring arms
  - Stroke counter and short stroke adjustment
  - Sliding chute fitted, easily allowing operator to retrieve cut pieces
  - Three safety photo electric light beams on rear guarding
- PB-135B PRESSBRAKE:
  - Swivel pendant control unit operated by Estun NC-E21 control
  - Sliding front sheet support arms
  - Emergency stop buttons conveniently located on control panel and foot control
  - Mobile dual operation foot control
  - Segmented 86° offset top punch
  - Solid one piece four way multi vee (V) die block
  - Top punch tool intermediate holder system with wedge type adjustment
  - Powered hardened ballscrew backgauge with 600mm travel, operated by Estun NC-E21 control
  - Oil tank level indicator
  - Metal constructed safety guarding surrounding machine with clear side viewing panels
  - Integrated hydraulic system allowing rapid approach switching automatically to slow bend
  - Includes safety control guarding system with light curtains fitted.

## Includes: Safety Guarding System for OHS Compliance

(S620A + S621B)

### FoldSafe Advantages:

1. Australian made genuine FoldSafe Safety Guarding System, manufactured & fitted in Australia.
2. The safest integrated dual redundant curtain system in Australia.
3. 100% Australian design, built and supported locally.
4. Dual e/stops safety gate circuits for maximum operator safety.
5. Encoder speed & stopping performance monitoring will ensure maximum safety in the rare case of hydraulic valve failure.
6. Italian made safety curtains & safety relays with a long protection height of 910mm @10ms.
7. Primary & secondary stop method design, if the primary stop detection fails, the secondary stop is still active monitoring machine ensuring maximum safety.
8. User friendly interface displaying status of machine, no guess work or codes.



Product Brochure For K058A

Specific Features



HG 1060B Guillotine



NC 89 Control Panel



Right View



NC 89 Backgauge DRO



Quick Action Blade Adjustment



Squaring Arm



Squaring Arm with Flip Over Stop



Front Sheet Supports with Roller Bearings



Material Transfer Ball On the Table



Motorised Backgauge



Motorised Backgauge Close Up



Motorised Backgauge Right View



Back Gauge Drive Motor



Micro Switches



3 Safety Photo Sensors



Safety Omron E3ZS Rear Light Sensor Guarding

Product Brochure For K058A



Rear Guard Reset Button



Emergency Stop Switch



One Shot Lubrication



Mobile Foot Control



Shown with Optional Ball Transfer Tables - Order Code (L840)



Quick Action Blade Clearance Adjustment



PB 1355B Pressbrake



Right View



Ezy Set NC 89 Go To Controller



Ezy Set NC 89



Adjustable Travel Limit Control



Enclosed Rear Safety Guarding

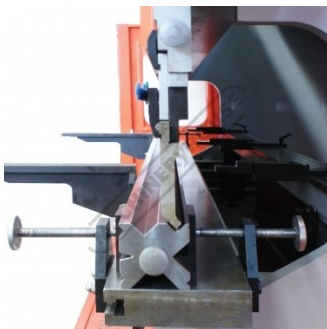

Top & Bottom Tooling



Quick Action Intermediate Clamps



Adjustable & Sliding Front Sheet Supports



Adjustable Pressure Control

Product Brochure For K058A

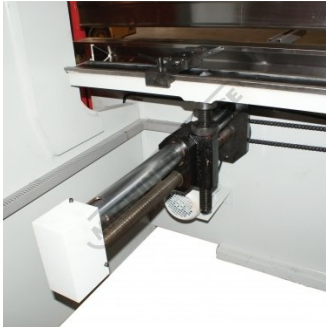

Ezy Set NC 89 Go To Back Gauge



Mobile Foot Control



Controller Top View



Adjustable Top Tool Taper Wedge System

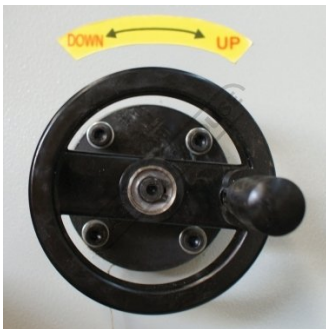

Fine Adjustment Beam Positioning



Fine Adjust Back Gauge



Synchronised Torsion Bar



Synchronised Torsion Bar

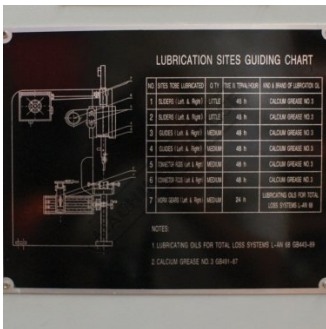

Lubrication Chart

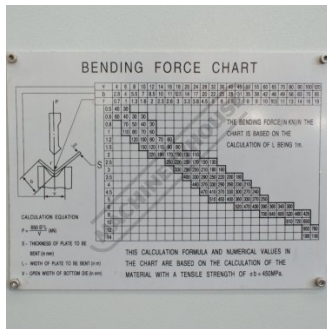

Tonnage Calculation Chart

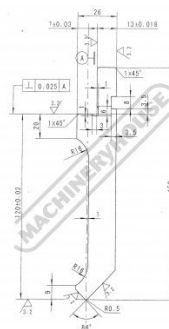

Segmented Top Punch

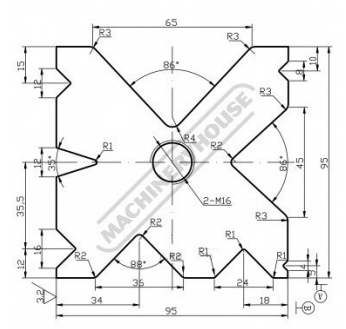

One Piece 4 Sided Die



Shown with Optional Ball Transfer Tables - Order Code (L840)

Product Brochure For K058A

---

**Recommended Accessories**

M800  
Rubber Mat - Anti-Fatigue

M805  
Rubber Mat - Anti-Fatigue

O043  
Rust & Corrosion Preventive

O042  
General Purpose Lubricant &  
Corrosion Inhibitor

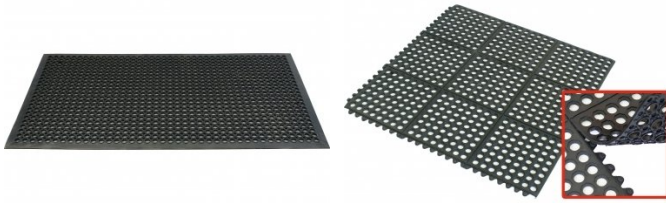

O044  
Rust & Corrosion Preventive

