

Product Brochure For C930

40 x 100 x ER32 Collet Chuck - Straight

Ø3-Ø26mm Range

ORDER CODE:	C930
MODEL:	40 x 100 x ER32
Shoulder Type (Yes / No):	Yes
D (mm):	50
D1 (mm):	40
L (mm):	54
L1 (mm):	100
Nett Weight (kg):	1.2

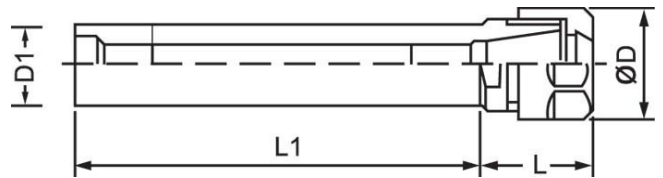

Description

Toolmaster Straight shanked ER collet chucks are suitable for applications such as turret work or can be used as an extension when a long reach is required

Note: Spanner not included

Features

- Precision ground
- Clamping flat

Product Brochure For C930

Recommended Accessories

C932
ER32 Collet Chuck Wrench

C117
Collet Nut ER32

C957
ER40 Collet Set - 7 Piece

C958
ER40 Collet Set - 23 Piece

