

Product Brochure For C274

4 Jaw Independent Lathe Chuck - K72-500/D1-11

Ø500mm

D1-11 Camlock Mount

Ex GST
\$1,452.00

Inc GST
\$1,669.80



ORDER CODE:	C274
Chuck Size (mm):	Ø500
Camlock:	D1-11
Speed (rpm):	800
D1 (mm):	196.8
D2 (mm):	235
D3 (mm):	160
H1 (mm):	106
h (mm):	16
Nett Weight (kg):	124

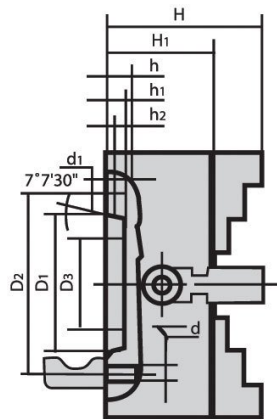

Description

Manufactured from High Strength semi steel and precision machined
Jaws are case-hardened to minimise wear
Operating screws are made from alloy steel and case-hardened.
Supplied with camlock pins, 1 set of jaws and wrench.

Product Brochure For C274

Specific Features



Front View



Camlock Mount



Included Accessories

Recommended Accessories

A358
Sky Hook Lifting Device

A358A
Chuck Hook

A358C
Bolt Down Adaptor

