

Product Brochure For C273

4 Jaw Independent Lathe Chuck - K72-400/D1-8

Ø400mm

D1-8 Camlock Mount

Ex GST
\$1,002.00

Inc GST
\$1,152.30



ORDER CODE:	C273
Chuck Size (mm):	Ø400
Camlock:	D1-8
Speed (rpm):	1000
D1 (mm):	139.7
D2 (mm):	171.4
D3 (mm):	125
H1 (mm):	95
h (mm):	14
Nett Weight (kg):	78

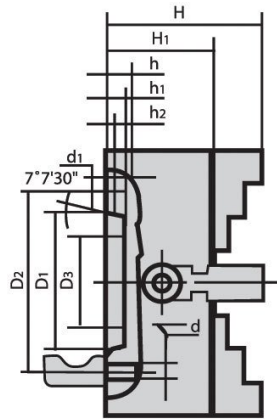

Description

Manufactured from High Strength semi steel and precision machined
Jaws are case-hardened to minimise wear
Operating screws are made from alloy steel and case-hardened
Supplied with camlock pins, 1 set of jaws and wrench

Product Brochure For C273

Specific Features



Camlock Mount



Included Accessories



Front View

Recommended Accessories

A358
Sky Hook Lifting Device

A358A
Chuck Hook

A358C
Bolt Down Adaptor

