

Product Brochure For C253

4 Jaw Independent Lathe Chuck - K72-200/D1-5

Ø200mm

D1-5 Camlock Mount

Ex GST
\$330.00

Inc GST
\$379.50

ORDER CODE:	C253
Chuck Size (mm):	Ø200
Camlock:	D1-5
Speed (rpm):	2000
D1 (mm):	82.5
D2 (mm):	104.8
D3 (mm):	56
H1 (mm):	75
h (mm):	12
Nett Weight (kg):	17.5

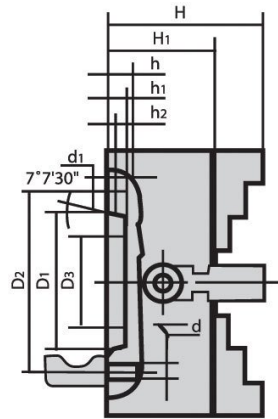

Description

Manufactured from High Strength semi steel and precision machined
Jaws are case-hardened to minimise wear
Operating screws are made from alloy steel and case-hardened.
Supplied with camlock pins, 1 set of jaws and wrench.

Product Brochure For C253

Specific Features



Camlock Mount



Included Accessories



Front View

Recommended Accessories

A358
Sky Hook Lifting Device



A358A
Chuck Hook



A358C
Bolt Down Adaptor

